

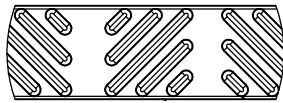

DPA-6in to 30in (PARALLEL STRAIGHT GRATE)

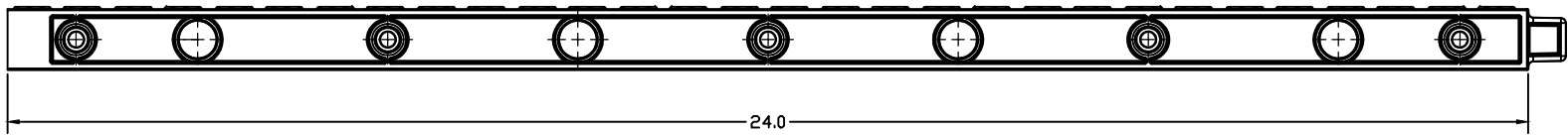
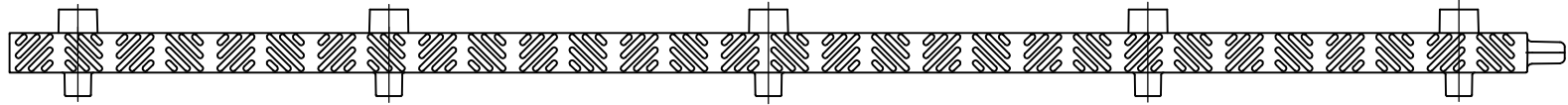

Raised Herringbone Design

15mm Fiberglass Rods for Load Strength Requirements

Parallel bars formed of UV stabilized and certified NSF-50 PVC. They are modular interlocking sections in 6inch to 30 inch widths.

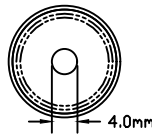
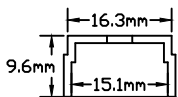

PVC Cap used to secure fiberglass rods in place

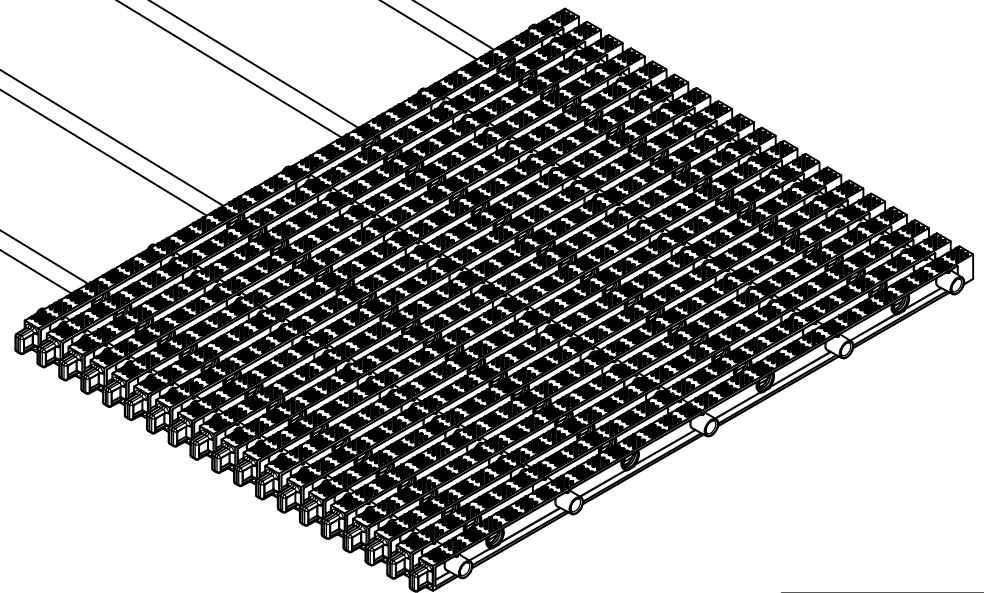

All drawing dimensions supplied by Daldorado are for reference only. All drawings are saved in a (*.dwg) file format and a provided as a service to our customers. Errors on occasion may occur when opening a file due to software incompatibility. Daldorado or any authorized distributor of our products will not be held responsible from files which have been converted and does not warranty the documents against deficiencies or typographical errors of any kind. We recommend that all mesurements are verified with the actual physical product before any custom fabrication in the field occurs.

DPA-(6' to 30') GRATING



REVISED 2/21/18 JMS